

CALL FOR MORE INFORMATION



PROPERTY SNAPSHOT



88,024
2023 POPULATION
3 MILE RADIUS



73,881
2023 DAYTIME POPULATION
3 MILE RADIUS



\$75,767
2023 AVERAGE INCOME
3 MILE RADIUS



110,423 VPD
I-2 / US 83

WASHINGTON
PRIME GROUP™

The information contained herein was obtained from sources deemed reliable; however, RESOLUT RE makes no guaranties, warranties or representations to the completeness or accuracy thereof. The presentation of this real estate information is subject to errors; omissions; change of price; prior sale or lease; or withdrawal without notice. RESOLUT RE, which provides real estate brokerage services, is a division of Reliance Retail, LLC, a Texas Limited Liability Company.

PROPERTY OVERVIEW

With almost a half-million square feet of retail space, Palms Crossing is a center-piece retail project for the entire Rio Grande Valley. Built in 2007, this site features big box anchors, specialty retailers, and a range of great restaurants - all in an inviting, open-air atmosphere conveniently located adjacent to the McAllen Convention Center and Civic Center.

PHASE 1

2nd Gen Retail 1,200 SF - 7,487 SF

FUTURE OPPORTUNITIES (PHASE II)

- Small Shop and Junior Box Spaces
- 1,200 SF & up!

TRAFFIC COUNT

I-2/US 83: 110,423 VPD
S Ware Rd: 39,026 VPD
(TXDot 2022)

AREA TRAFFIC GENERATORS



Patricia Rodriguez
patricia@resolutre.com
956.412.8800

Joaquin Orozco
jorozco@resolutre.com
281.445.0033

www.resolutre.com

Phase I Site Plan



147,825 VPD



Patricia Rodriguez
patricia@resolutre.com
956.412.8800

Joaquin Orozco
jorozco@resolutre.com
281.445.0033

www.resolutre.com



WASHINGTON PRIME GROUP™

The information contained herein was obtained from sources deemed reliable; however, RESOLUT RE makes no guaranties, warranties or representations to the completeness or accuracy thereof. The presentation of this real estate information is subject to errors; omissions; change of price; prior sale or lease; or withdrawal without notice. RESOLUT RE, which provides real estate brokerage services, is a division of Reliance Retail, LLC, a Texas Limited Liability Company.

Phase II Site Plan

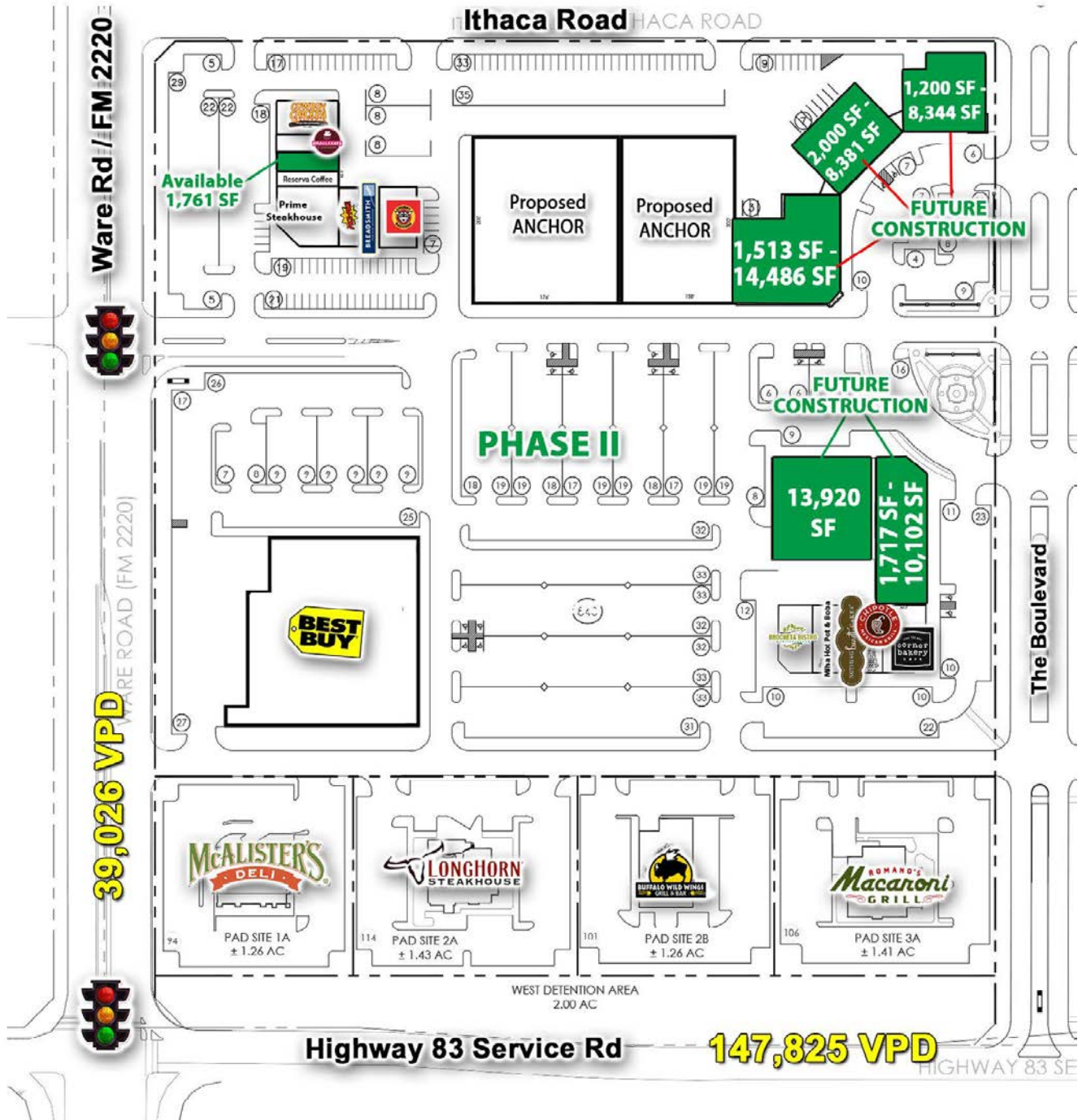

Patricia Rodriguez
patricia@resolutre.com
 956.412.8800

Joaquin Orozco
jorozco@resolutre.com
 281.445.0033

www.resolutre.com



WASHINGTON PRIME GROUP™

The information contained herein was obtained from sources deemed reliable; however, RESOLUT RE makes no guaranties, warranties or representations to the completeness or accuracy thereof. The presentation of this real estate information is subject to errors; omissions; change of price; prior sale or lease; or withdrawal without notice. RESOLUT RE, which provides real estate brokerage services, is a division of Reliance Retail, LLC, a Texas Limited Liability Company.

Phase II Site Plan

Shops B



Shops C

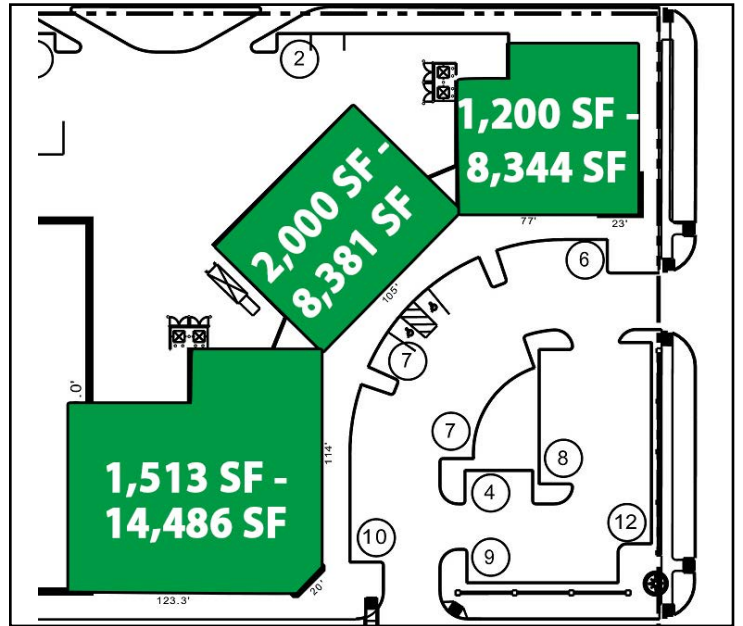

Shops F

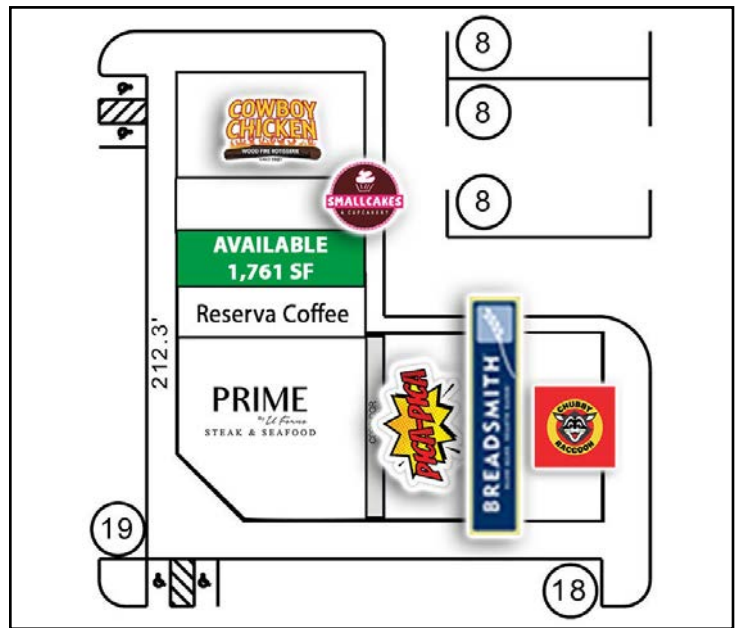

Patricia Rodriguez
patricia@resolutre.com
956.412.8800

Joaquin Orozco
jorozco@resolutre.com
281.445.0033

www.resolutre.com



WASHINGTON
PRIME GROUP™

The information contained herein was obtained from sources deemed reliable; however, RESOLUT RE makes no guaranties, warranties or representations to the completeness or accuracy thereof. The presentation of this real estate information is subject to errors; omissions; change of price; prior sale or lease; or withdrawal without notice. RESOLUT RE, which provides real estate brokerage services, is a division of Reliance Retail, LLC, a Texas Limited Liability Company.



Patricia Rodriguez
patricia@resolutre.com
 956.412.8800

Joaquin Orozco
jorozco@resolutre.com
 281.445.0033

www.resolutre.com



WASHINGTON PRIME GROUP™

The information contained herein was obtained from sources deemed reliable; however, RESOLUT RE makes no guaranties, warranties or representations to the completeness or accuracy thereof. The presentation of this real estate information is subject to errors; omissions; change of price; prior sale or lease; or withdrawal without notice. RESOLUT RE, which provides real estate brokerage services, is a division of Reliance Retail, LLC, a Texas Limited Liability Company.

Palms Crossing

NWC EXPRESSWAY 83 & WARE RD
3300 EXPRESSWAY 83 | MCALEN, TX 78501



aerial photography provided by videalty.com



aerial photography provided by videalty.com

Patricia Rodriguez
patricia@resolutre.com
956.412.8800

Joaquin Orozco
jorozco@resolutre.com
281.445.0033

www.resolutre.com



WASHINGTON PRIME GROUP™

The information contained herein was obtained from sources deemed reliable; however, RESOLUT RE makes no guaranties, warranties or representations to the completeness or accuracy thereof. The presentation of this real estate information is subject to errors; omissions; change of price; prior sale or lease; or withdrawal without notice. RESOLUT RE, which provides real estate brokerage services, is a division of Reliance Retail, LLC, a Texas Limited Liability Company.

Palms Crossing

NWC EXPRESSWAY 83 & WARE RD
3300 EXPRESSWAY 83 | MCALEN, TX 78501



Patricia Rodriguez
patricia@resolutre.com
956.412.8800

Joaquin Orozco
jorozco@resolutre.com
281.445.0033

www.resolutre.com



**WASHINGTON
PRIME GROUP™**

The information contained herein was obtained from sources deemed reliable; however, RESOLUT RE makes no guaranties, warranties or representations to the completeness or accuracy thereof. The presentation of this real estate information is subject to errors; omissions; change of price; prior sale or lease; or withdrawal without notice. RESOLUT RE, which provides real estate brokerage services, is a division of Reliance Retail, LLC, a Texas Limited Liability Company.

Palms Crossing

NWC EXPRESSWAY 83 & WARE RD
3300 EXPRESSWAY 83 | MCALEN, TX 78501

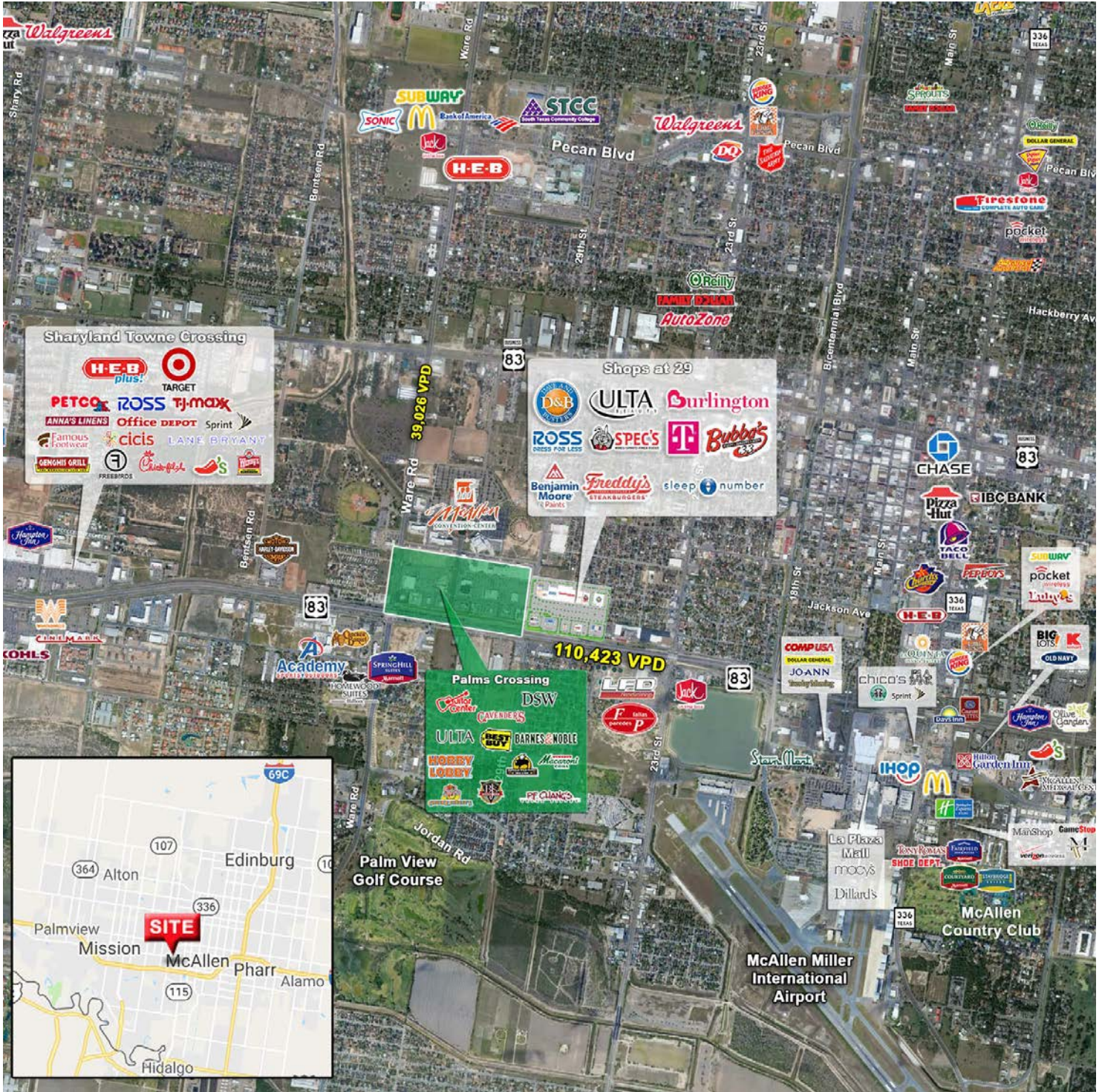

Patricia Rodriguez
patricia@resolutre.com
 956.412.8800

Joaquin Orozco
jorozco@resolutre.com
 281.445.0033

www.resolutre.com



WASHINGTON PRIME GROUP™

The information contained herein was obtained from sources deemed reliable; however, RESOLUT RE makes no guaranties, warranties or representations to the completeness or accuracy thereof. The presentation of this real estate information is subject to errors; omissions; change of price; prior sale or lease; or withdrawal without notice. RESOLUT RE, which provides real estate brokerage services, is a division of Reliance Retail, LLC, a Texas Limited Liability Company.

